



FLORINA

Descriptions

| | |
|---------------------|---|
| Product code | CC5964FN10 |
| Product description | Florina brown hanging chair Want to create an exotic feel at home? This polyrattan design is a must for lounging indoors or in your covered outdoor spaces. With comfy cushions included, get ready for a new level of relaxation. |
| Origin country | CN |

Dimensions

| | | | | | |
|-----------------------------|--------|---|-------|---|-------|
| Height x Width x Depth (cm) | 120 cm | x | 86 cm | x | 64 cm |
| Product weight (kg) | 7 Kg | | | | |
| Seat height (cm) | 68 cm | | | | |
| Seat width (cm) | 50 | | | | |
| Seat depth (cm) | 82 | | | | |
| Armrest height (cm) | | | | | |
| Armrest width (cm) | | | | | |

Technical drawings

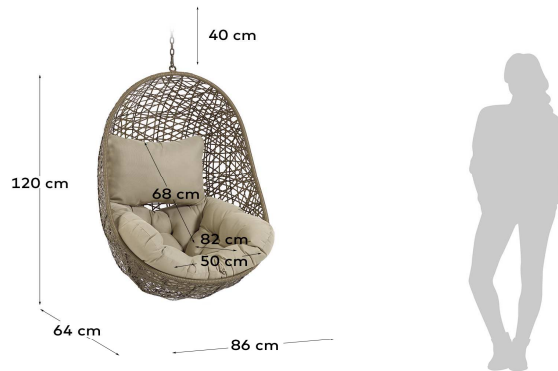

Features

| | |
|--------------------------------|-----------|
| Use (domestic/contract/office) | Domestic+ |
| Indoor (yes/no) | Yes |
| Alfresco (yes/no) | Yes |
| Outdoor (yes/no) | No |
| Seating capacity | 1 |
| Max. load (kg) | 110 |
| Stackable (yes/no) | N/A |
| Stacks up to | |
| Foldable (yes/no) | No |

| | |
|--|-----|
| Reclining (yes/no) | No |
| Sliding seat (yes/no) | No |
| Swivel (yes/no) | No |
| Fabric durability resistance (Martindale cycles) | |
| Water repellent (yes/no) | No |
| Stain resistant (yes/no) | No |
| Fire resistant (yes/no) | No |
| UV resistance level (1-5) | 3 |
| Seat detachable (yes/no) | Yes |
| Seat removable cover (yes/no) | No |
| Backrest detachable (yes/no) | |
| Backrest removable cover (yes/no) | |
| Adjustable feet (yes/no) | |
| Armrest included (yes/no) | |
| Armrest type | |
| Armrest removable cover (yes/no) | |
| Headrest included (yes/no) | No |
| Headrest detachable (yes/no) | |
| Headrest removable cover (yes/no) | |
| Cushion included (yes/no) | Yes |
| Number of cushions | 1 |
| Cushion removable cover (yes/no) | No |
| Storage included (yes/no) | N/A |
| Storage capacity (l) | |
| Storage lifting mechanism | N/A |
| Footrest included (yes/no) | N/A |
| Footstool included (yes/no) | |

Materials

| | |
|-------------------------------|------------------------------------|
| Main material | Wicker/Rattan/Other natural fibers |
| Fabric type & specifications | Acrylic fibers |
| Fabric composition | 100% Polyester |
| Fabric grammage (g/m2) | |
| Frame construction | Steel |
| Seat material details | Polyester, Cotton |
| Seat fill material | Cotton |
| Seat foam density (kg/m3) | |
| Backrest material details | Polyester, Cotton |
| Backrest fill material | Cotton |
| Backrest foam density (kg/m3) | |
| Legs material | |
| Legs finishing | |
| Feet pad type | |
| Armrest material details | |
| Armrest density foam (kg/m3) | |
| Headrest material details | |
| Headrest density foam (kg/m3) | |
| Cushion fabric type | Acrylic fibers |
| Cushion fabric composition | 100% Polyester |
| Cushion grammage (g/m2) | |
| Cushion fill material | Cotton |
| Cushion thickness (cm) | 15 |

Assembly

| | |
|----------------------------|------------------------------------|
| Unpacking time (min) | 3 |
| Assembly required (yes/no) | No |
| Difficulty of assembly | This does not apply to the product |
| People required | |
| Assembly time (min) | |
| Assembly suggestions | |

Assembly instructions

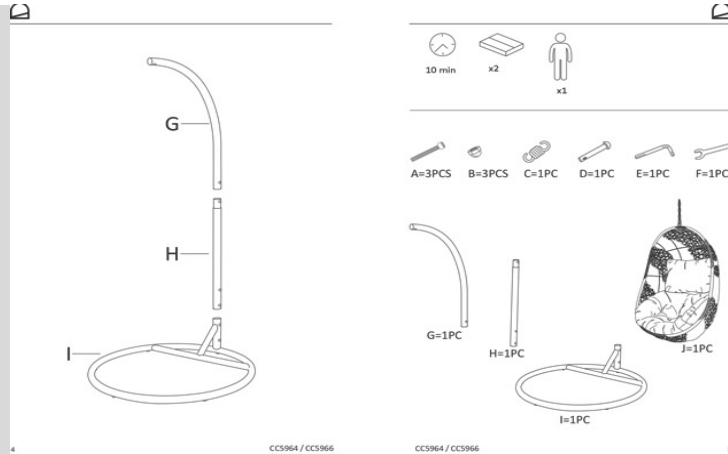

Care & Warranties

| | |
|--|--|
| General warnings | Use appropriate fittings to fix your product to the ceiling or to the supporting structure. We recommend this installation to be done by a professional. Periodically check the wear and fittings as they have not deteriorated. |
| Specific use and care instructions | Seat cushions and backrest cushions: Cold washing. Other parts: Clean with a dry cloth |
| Specific use and care instructions for outdoor | Store the furniture in a dry indoor place. If you want to leave it outdoors, protect it with a waterproof cover in autumn, winter and rainy season. |
| Years of guarantee | 2 |
| Made according to | EN 581:2017 for outdoor household use seats |
| FSC certified (yes/no) | N/A |
| PEFC certified (yes/no) | N/A |
| FLEGT license (yes/no) | N/A |
| Variation type | No natural variation, Light and environment conditions may distort the color |
| Purposeful distressing type | No distressing |
| Additional information | Heavy load, sun exposure and wet weather reduce product life. Before use check the resistance of product as it hasn't loss capacity. Never leave children alone in product. Do not stand on it; your product is not a gym equipment. Not misuse as a swing |

Packaging

| | | | | | |
|--|-----------------------------|---|------|---|----|
| Units per lot | | | | | |
| Cbm (m3) / Gross weight (Kg) | 0,715 | / | 20,2 | | |
| Nº of boxes | 1 | | | | |
| Box 1 | 1 | | | | |
| Description | Florina brown hanging chair | | | | |
| Description box | FULL ITEM | | | | |
| Height x Width x Depth (cm) | 65,5 | x | 127 | x | 86 |
| Cbm (m3) / Gross weight (Kg) / Net weight (Kg) | 0,715 | / | 20,2 | / | 7 |
| Box 2 | | | | | |
| Description | | | | | |
| Description box | | | | | |
| Height x Width x Depth (cm) | | x | | x | |
| Cbm (m3) / Gross weight (Kg) / Net weight (Kg) | | / | | / | |
| Box 3 | | | | | |
| Description | | | | | |
| Description box | | | | | |
| Height x Width x Depth (cm) | | x | | x | |
| Cbm (m3) / Gross weight (Kg) / Net weight (Kg) | | / | | / | |

