



OFF

Descriptions

Product code	S289J15
Product description	OFF Armchair wood natural fabric dark grey Armchair in scandinavian design upholstered with fabric Miss pattern. Backrest with decorative stichings. Legs in natural wood.
Origin country	CN

Dimensions

Height x Width x Depth (cm)	81 cm	x	90 cm	x	81 cm
Product weight (kg)	21,6 Kg				
Seat height (cm)	44				
Seat width (cm)	49				
Seat depth (cm)	55				
Armrest height (cm)	61				
Armrest width (cm)	15				

Technical drawings



Features

Use (domestic/contract/office)	Domestic
Indoor (yes/no)	Yes
Alfresco (yes/no)	No
Outdoor (yes/no)	No
Seating capacity	1
Max. load (kg)	130
Stackable (yes/no)	No
Stacks up to	
Foldable (yes/no)	No

Reclining (yes/no)	No
Sliding seat (yes/no)	No
Swivel (yes/no)	No
Fabric durability resistance (Martindale cycles)	>40.000
Water repellent (yes/no)	No
Stain resistant (yes/no)	No
Fire resistant (yes/no)	No
UV resistance level (1-5)	
Seat detachable (yes/no)	No
Seat removable cover (yes/no)	No
Backrest detachable (yes/no)	No
Backrest removable cover (yes/no)	No
Adjustable feet (yes/no)	No
Armrest included (yes/no)	Yes
Armrest type	Round
Armrest removable cover (yes/no)	No
Headrest included (yes/no)	No
Headrest detachable (yes/no)	N/A
Headrest removable cover (yes/no)	N/A
Cushion included (yes/no)	No
Number of cushions	
Cushion removable cover (yes/no)	N/A
Storage included (yes/no)	No
Storage capacity (l)	
Storage lifting mechanism	N/A
Footrest included (yes/no)	No
Footstool included (yes/no)	No

Materials

Main material	Fabric
Fabric type & specifications	Plain fabric
Fabric composition	96% Polyester, 4% Nylon
Fabric grammage (g/m2)	410
Frame construction	Plywood, Steel
Seat material details	Eucalyptus wood (Eucalyptus camaldunensis), Foam, Plywood
Seat fill material	Foam
Seat foam density (kg/m3)	34
Backrest material details	Eucalyptus wood (Eucalyptus camaldunensis), Foam, Plywood
Backrest fill material	Foam
Backrest foam density (kg/m3)	20
Legs material	Oak wood (Quercus alba)
Legs finishing	Clear, Lacquered
Feet pad type	Felt pad
Armrest material details	Foam, Plywood
Armrest density foam (kg/m3)	22
Headrest material details	N/A
Headrest density foam (kg/m3)	
Cushion fabric type	N/A
Cushion fabric composition	
Cushion grammage (g/m2)	
Cushion fill material	N/A
Cushion thickness (cm)	

Assembly

Unpacking time (min)	3
Assembly required (yes/no)	Yes
Difficulty of assembly	Easy
People required	1
Assembly time (min)	10
Assembly suggestions	The legs are inside the frame. Check and classify all fittings before starting the assembly. Assemble on a soft surface.

Assembly instructions

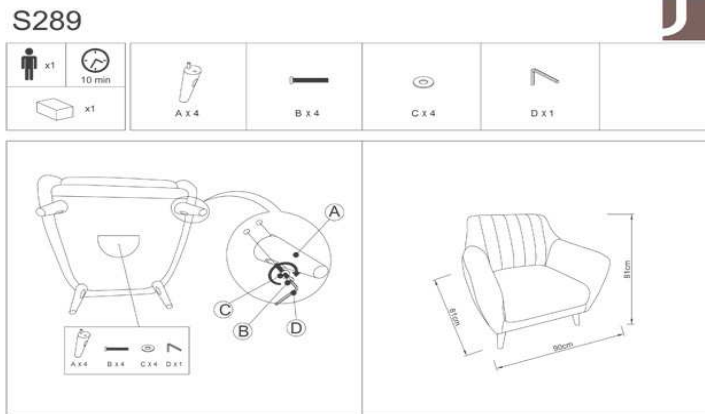

This product is property of Julia Grup Furniture Solutions S.L. (B-17616277) Pol. Ind. Bosc d'en Cucu C/Tallers, 14 17410 Slls - SPAIN

Care & Warranties

General warnings	Do not place near direct sources of heat. Keep away from direct solar light. Do not use abrasive products like acetones, bleaches, solvents, etc. Sharp elements can scratch the product surface.
Specific use and care instructions	Clean brushing it with a soft brush or with a dry cloth. If some liquid is spilt over the product, clean it as fast as possible to avoid making stains. Dust it with a duster.
Specific use and care instructions for outdoor	
Years of guarantee	2
Made according to	EN 12520:2015 for household use seats
FSC certified (yes/no)	No
PEFC certified (yes/no)	No
FLEGT license (yes/no)	N/A
Variation type	No natural variation, Light and environment conditions may distort the color
Purposeful distressing type	No distressing
Additional information	Wood origin country: China

Packaging

Units per lot					
Cbm (m3) / Gross weight (Kg)	0,43	/	26,9		
Nº of boxes	1				
Box 1	1				
Description	OFF Armchair wood natural fabric dark grey				
Description box	L-SHAPPED BOX				
Height x Width x Depth (cm)	67	x	82	x	92
Cbm (m3) / Gross weight (Kg) / Net weight (Kg)	0,430	/	26,9	/	21,6
Box 2					
Description					
Description box					
Height x Width x Depth (cm)		x		x	
Cbm (m3) / Gross weight (Kg) / Net weight (Kg)		/		/	
Box 3					
Description					
Description box					
Height x Width x Depth (cm)		x		x	
Cbm (m3) / Gross weight (Kg) / Net weight (Kg)		/		/	

