



QUATRE

Descriptions

Product code	A792M50
Product description	QUATRE Tv cabinet 134x56 ash wood, matt white mdf TV stand with doors and legs in ash wood. White lacquered fiberboard structure.
Origin country	CN

Dimensions

Height x Width x Depth (cm)	56 cm	x	134 cm	x	45 cm
Product weight (Kg)	40,3 Kg				

Technical drawings

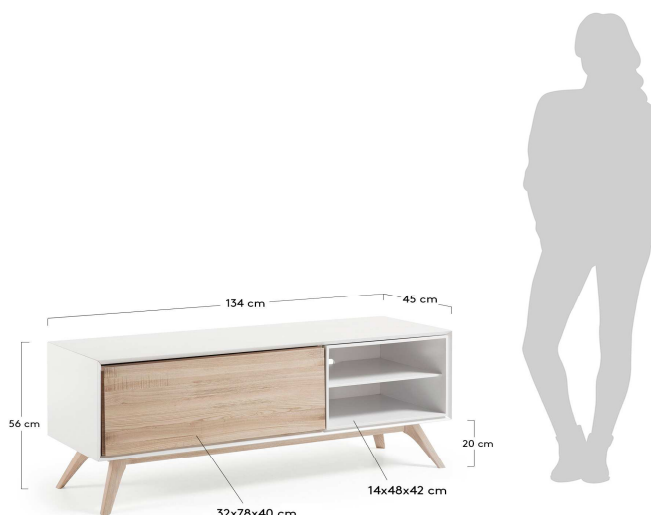

Features

Use (domestic/contract/office)	Domestic
Indoor (yes/no)	Yes
Alfresco (yes/no)	No
Outdoor (yes/no)	No
Max. load (kg)	60
Adjustable height (yes/no)	No
Adjustable height mechanism description	N/A
Top tilt angle range	
Feet pad type	Felt pad
Adjustable feet (yes/no)	No
Doors included (yes/no)	Yes
Number of doors	1
Door opening system	Pulling folding door
Door soft-close function (yes/no)	Yes
Drawers included (yes/no)	No
Number of drawers	

Drawer opening system	N/A
Runner guide mechanism	N/A
Runner soft-close function (yes/no)	N/A
Drawers max. load (kg)	N/A
Shelves included (yes/no)	Yes
Number of shelves	1
Adjustable shelves (yes/no)	No
Shelves max. load (kg)	5
Wall brackets antitilting included (yes/no)	No

Materials

Material description	N/A
Finishing description	No
Back processed (yes/no)	No
Legs material	Ash wood (Fraxinus spp.)
Legs finishing	Natural
Door material	MDF (Medium density fibers)
Drawer material	N/A
Runner material of the drawers	N/A
Shelves material	MDF (Medium density fibers)

Assembly

Unpacking time (min)	3
Assembly required (yes/no)	Yes
Difficulty of assembly	Medium
People required	2
Assembly time (min)	60
Assembly suggestions	Check and classify all fittings before starting the assembly. Assemble on a soft surface.

Assembly instructions

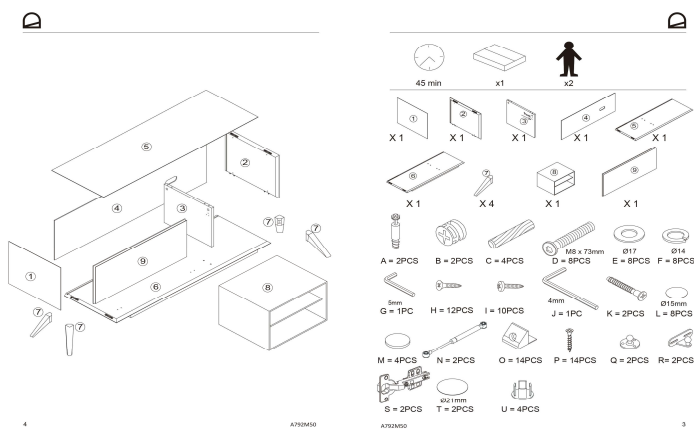

Care & Warranties

General warnings	Do not place near direct sources of heat. Keep away from direct solar light. Do not use abrasive products like acetones, bleaches, solvents, etc. Sharp elements can scratch the product surface.
Specific use and care instructions	Clean the product with a wet cloth dampened in a mild cleaner and dry immediately. Dust it with a duster.
Specific use and care instructions for outdoor	
Years of guarantee	2
Made according to	
FSC certified (yes/no)	No
PEFC certified (yes/no)	No
FLEGT license (yes/no)	N/A

Variation type	Natural wood grain and/or Colour tone, Light and environment conditions may
Purposeful distressing type	No distressing
Additional information	Wood origin country: China

Packaging

Units per lot	
Cbm (m3) / Gross weight (Kg)	0,265 / 44
Nº of boxes	2

Box 1	1
Description	QUATRE Tv cabinet 134x56 ash wood, matt white mdf
Description box	1,2,3,4,5,6,7,9
Height x Width x Depth (cm)	19 x 150 x 53
Cbm (m3) / Gross weight (Kg) / Net weight (Kg)	0,151 / 36 / 33,3

Box 2	2
Description	QUATRE Tv cabinet 134x56 ash wood, matt white mdf
Description box	8
Height x Width x Depth (cm)	40 x 56 x 51
Cbm (m3) / Gross weight (Kg) / Net weight (Kg)	0,114 / 8 / 7

Box 3	
Description	
Description box	
Height x Width x Depth (cm)	x x
Cbm (m3) / Gross weight (Kg) / Net weight (Kg)	/ /

Box 4	
Description	
Description box	
Height x Width x Depth (cm)	x x
Cbm (m3) / Gross weight (Kg) / Net weight (Kg)	/ /

Box 5	
Description	
Description box	
Height x Width x Depth (cm)	x x
Cbm (m3) / Gross weight (Kg) / Net weight (Kg)	/ /