



KENNA

Descriptions

Product code	C631S05
Product description	KENNA Armchair natural wood plastic white Armchair in polypropylene. Legs in solid natural beech wood.
Origin country	CN

Dimensions

Height x Width x Depth (cm)	81 cm	x	62 cm	x	61 cm
Product weight (kg)	5,7 Kg				
Seat height (cm)	46				
Seat width (cm)	36				
Seat depth (cm)	42,5				
Armrest height (cm)	69				
Armrest width (cm)	13				
Backrest height (cm)	35				

Technical drawings



Features

Use (domestic/contract/office)	Domestic
Indoor (yes/no)	Yes
Alfresco (yes/no)	No
Outdoor (yes/no)	No
Stackable (yes/no)	No
Stacks up to	
Max. load (kg)	130
Adjustable height (yes/no)	No
Adjustable height mechanism description	N/A

Foldable (yes/no)	No
Swivel (yes/no)	No
Reclining (yes/no)	No
Armrest included (yes/no)	Yes
Padded (yes/no)	No
Footrest included (yes/no)	No
Fabric durability resistance (Martindale cycles)	
Water repellent (yes/no)	N/A
Stain resistant (yes/no)	N/A
Fire resistant (yes/no)	Yes
UV resistance level (1-5)	
Removable chair cover (yes/no)	No
Removable cover parts description	N/A
Adjustable feet (yes/no)	No
Castors information	N/A
Cushion included (yes/no)	No
Cushion removable cover (yes/no)	N/A

Materials

Main material	Plastic
Frame construction	Plastic
Main finishing	Colored
Seat material details	Polypropylene
Backrest material details	Polypropylene
Armrest material details	Polypropylene
Fabric type & specifications	N/A
Fabric composition	
Fabric grammage (g/m2)	
Upholstery fill material	N/A
Foam density (kg/m3)	
Legs material	Beech wood (Fagus Sylvatica), Steel
Legs finishing	Clear, Lacquered
Feet pad type	Plastic pad
Cushion fabric type	N/A
Cushion fabric composition	
Cushion grammage (g/m2)	
Cushion fill material	N/A
Cushion thickness (cm)	

Assembly

Unpacking time (min)	5
Assembly required (yes/no)	Yes
Difficulty of assembly	Easy
People required	1
Assembly time (min)	15
Assembly suggestions	Join the legs to the frame and then screw them to the seat. Check and classify all fittings before starting the assembly. Assemble on a soft surface.

Assembly instructions

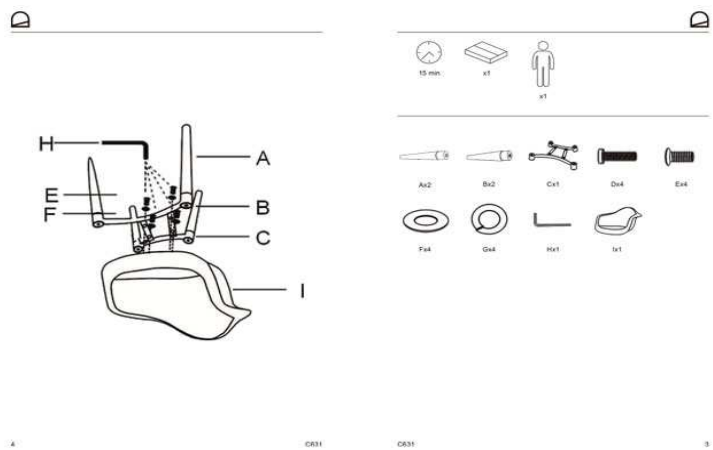

Care & Warranties

General warnings	Do not place near direct sources of heat. Keep away from direct solar light. Do not use abrasive products like acetones, bleaches, solvents, etc. Sharp elements can scratch the product surface.
Specific use and care instructions	Clean the product with a wet cloth dampened in a mild cleaner and dry immediately. Dust it with a duster.
Specific use and care instructions for outdoor	N/A
Years of guarantee	2
Made according to	EN 12520:2015+EN1022:2018 for household use seats
FSC certified (yes/no)	No
PEFC certified (yes/no)	No
FLEGT license (yes/no)	N/A
Variation type	Natural wood grain and/or Colour tone
Purposeful distressing type	No distressing
Additional information	Wood origin country: Denmark. PVC feet protection, Ø1 cm

Packaging

Units per lot	
Cbm (m3) / Gross weight (Kg)	0,082 / 7,25
Nº of boxes	1
Box 1	1
Description	KENNA Armchair natural wood plastic white
Description box	FULL ITEM
Height x Width x Depth (cm)	40 x 65 x 63
Cbm (m3) / Gross weight (Kg) / Net weight (Kg)	0,082 / 7,25 / 5,7
Box 2	
Description	
Description box	
Height x Width x Depth (cm)	x x
Cbm (m3) / Gross weight (Kg) / Net weight (Kg)	/ /
Box 3	
Description	
Description box	
Height x Width x Depth (cm)	x x
Cbm (m3) / Gross weight (Kg) / Net weight (Kg)	/ /